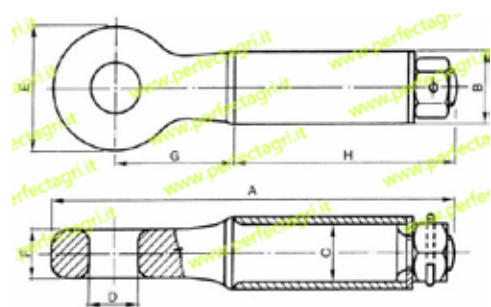

**OCCHIONE GIREVOLE PER TIMONE
TOWING EYES**

**OCCHIONE GIREVOLE PER TIMONE A NORME "CUNA" (PER OMOLOGAZIONI ITALIANE)
DRAWBAR SLEWING TOWING EYES "CUNA" STANDARDS (FOR ITALIAN HOMOLOGATIONS)**

Art.	N° omologaz.	Dimensioni								Carichi		Carico dinamico	Materiale
		A	ØB	ØC	ØD	E	F	G	H	Trainabile	Verticale		
3002	"E" 1398	350	60	49	35	95	30	110	193	6000	-	-	Fe 510
3003	"E1" 1483	260	42	30	22	62	20	90	142	3000	250	1000	35 Cr.Mo.4
3005	"E2" 1406	345	60	49	35	95	30	110	193	6000	500	3000	35 Cr.Mo.4
3006	"E3" 1407	350	60	49	35	95	30	110	193	6000	1500	4500	38 Ni.Cr.Mo.4
3007	"F" 1399	380	63	49	45	110	32	130	193	12000	-	-	Fe 52
3008	"F1" 1400	445	76	59	68	152	42	170	202	20000	-	-	35 Cr.Mo.4
3009	"F2" 1408	405	70	57	50	120	35	150	199	14000	2000	5050	35 Cr.Mo.4
3012	"F2" 1802	405	82	62	50	120	35	150	210	14000	2000	6000	39 Ni.Cr.Mo.4
3010	"F3" 1409	475	76	59	76	160	42	190	202	20000	2500	5000	38 Ni.Cr.Mo.4
3011	"F3" 1700	475	89	69	76	160	42	190	235	20000	2500	7500	38 Ni.Cr.Mo.4

**OCCHIONE GIREVOLE PER TIMONE (NON OMOLOGABILE)
DRAWBAR SLEWING TOWING EYES (IT CANNOT BE HOMOLOGATED)**

Art.	Tipo	Dimensioni								Carichi	
		A	ØB	ØC	ØD	E	F	G	H	Trainabile	Verticale
3015	Piccolo	280	42	31	30	85	25	95	143	-	-
3018	"E 990 Ø51"	340	51	39	42	104	30	96	192	6000	1100
3019	"E 990 Ø57"	340	57	40	42	105	31	96	192	6000	1100
3022	"E 701"	340	48	37	43	108	34	115	170	6000	-
3026	"F 987 Ø63"	354	63	51	45	112	42	98	200	12000	2090
3027	"F 987 Ø67"	354	67	51	45	112	42	98	200	12000	2090
3030	"F 702"	343	60	45	45	100	37	120	173	12000	-
3033	"E mon. 414"	340	60	48	45	100	37	120	172	6000	2500
3035	"E mon. 988 Ø63"	348	63	52	45	105	36	98	196	6000	2300
3036	"E mon. 988 Ø67"	348	67	52	45	105	36	98	196	6000	2300
3037	"E mon. 989"	348	63	50	45	105	36	98	195	6000	3100
3045	Francia L/BBM	330	60	48	51	128	37	85	183	-	-
3046	Francia L/BPT	324	58	45	52	128	37	87	175	-	-
3048	Francia P/MG	393	76	59	45	125	45	120	160	25000	-
3050	Francia P/BBM	380	82	61	50	130	51	105	205	25000	2000